

Signed for and on behalf of the Western Australian Planning Commission

Witness  
Date  
Approved - Minister for Planning  
Date

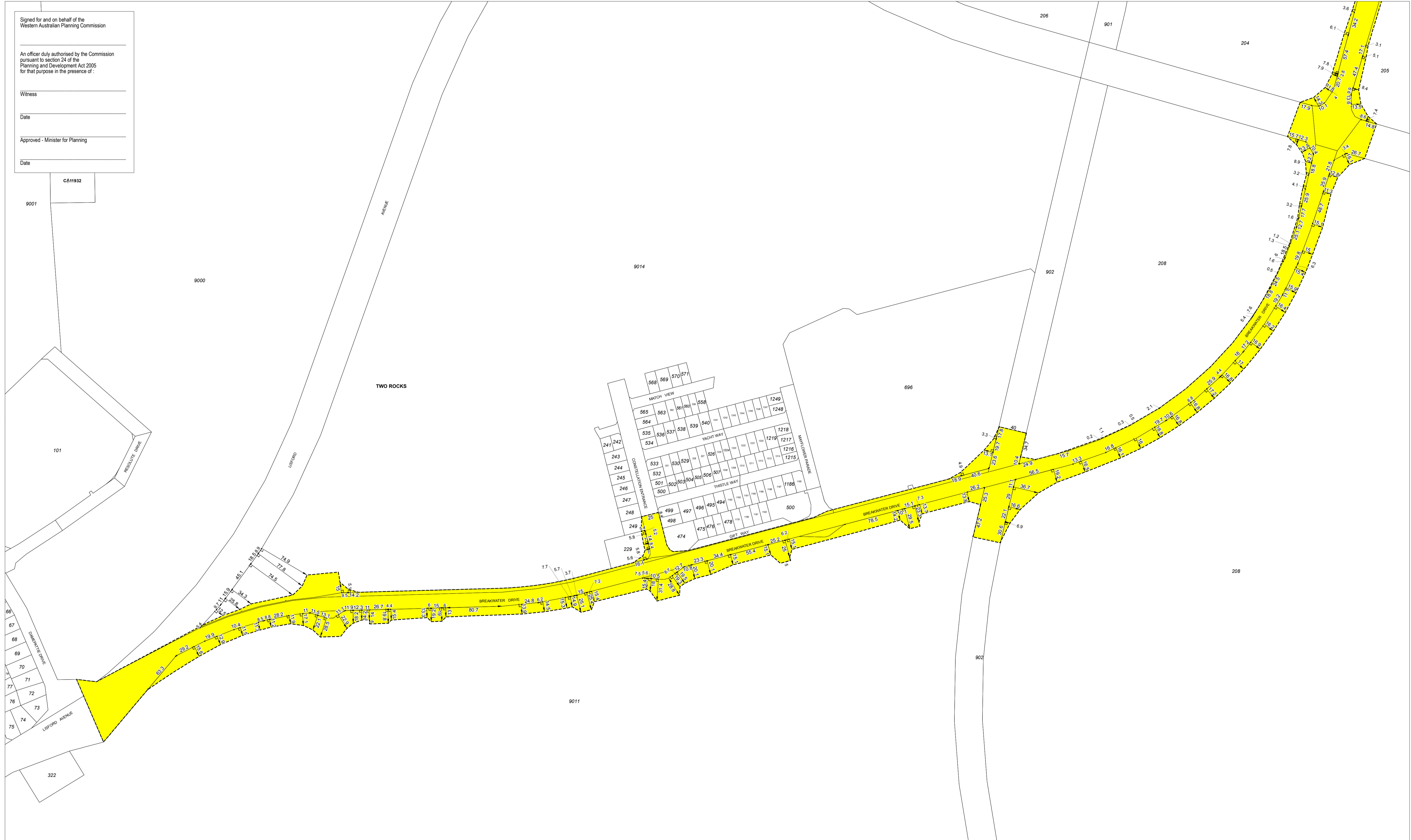

Planning control area No: 140

PCA NO. 140 - WANNEROO CITY - BREAKWATER DRIVE



Legend  
[Yellow shaded area] Planning control area

Program Manager: P. Jahmeerbacus  
Geospatial Officer: J. Ballarotta  
Examined: A. Power  
Revised:  
Version No: 2  
Date: 21 August 2019

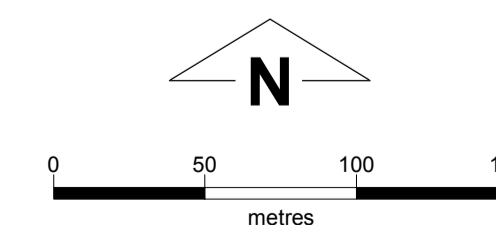

Plan Number  
**1.7910**

File number: 835/02/30/0015  
Plan reference:  
Metropolitan Region Scheme  
1:25,000 sheet 1  
Amending Plans:  
1.7910, 1.7911, 1.7912, 1.7913

Ref: 3008 Sheet 1 of 4

Signed for and on behalf of the  
Western Australian Planning Commission

---

An officer duly authorised by the Commission  
pursuant to section 24 of the  
Planning and Development Act 2005  
for that purpose in the presence of :

---

Witness

---

Date

---

Approved - Minister for Planning

---

Date

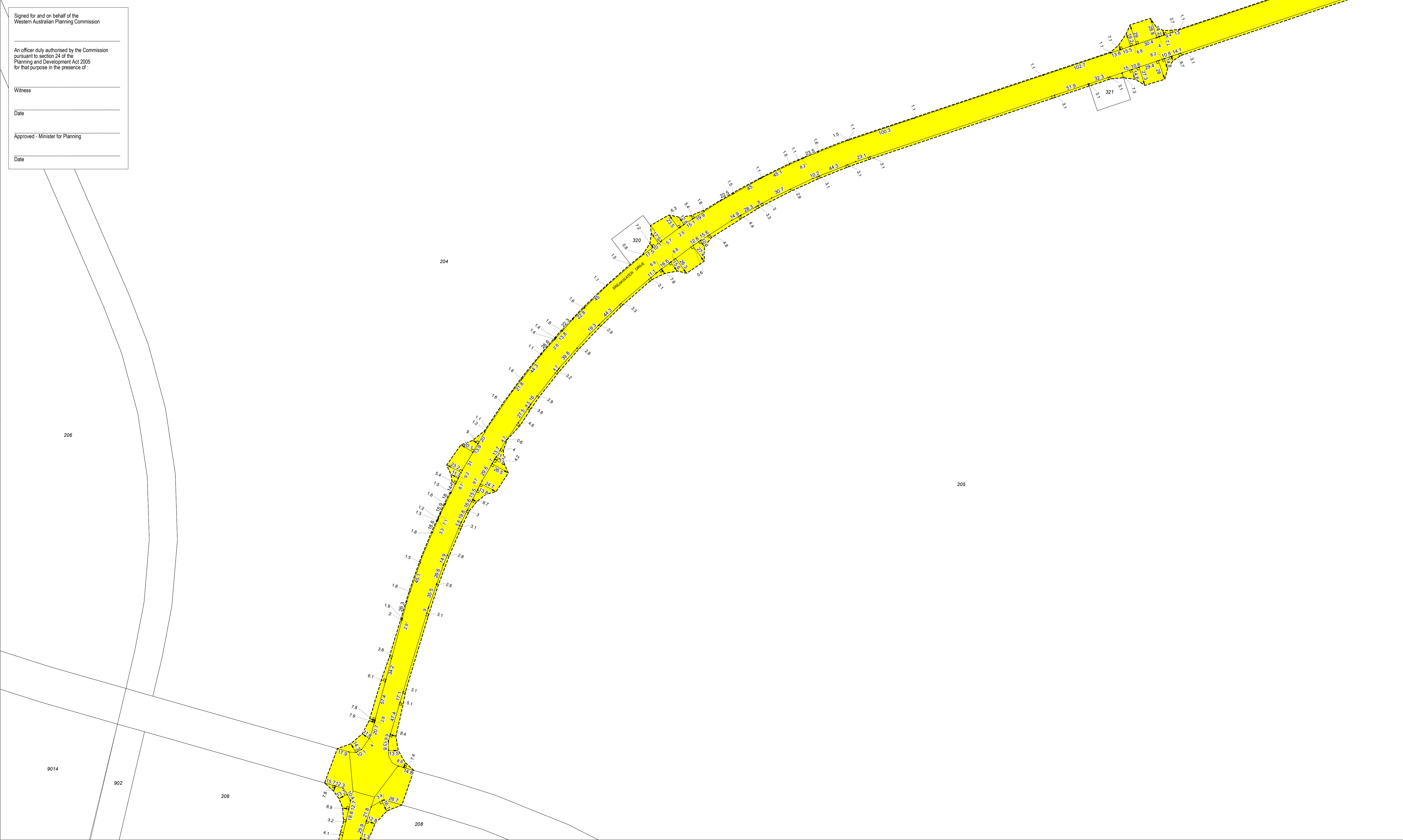

**Planning control area No: 140** **PCA NO. 140 - WANNEROO CITY - BREAKWATER DRIVE**

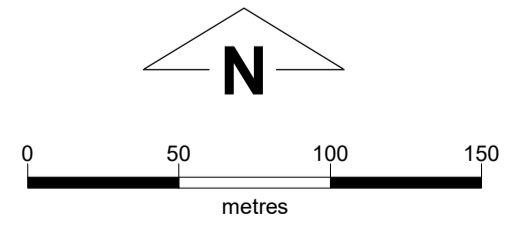
 <p>Created on date: Wednesday, 7 August 2019 Produced by Data Analytics, Department of Planning, Lands and Heritage, Perth WA Base information supplied by Western Australian Land Information Authority SLIP 1096-2018-1</p>	<p><b>Legend</b></p> <p><span style="display: inline-block; width: 15px; height: 10px; background-color: yellow; border: 1px solid black; margin-right: 5px;"></span> Planning control area</p>	<p>Program Manager: P. Jahmeerbacus Geospatial Officer: J. Ballarotta Examined: A. Power Revised: Version No: 2 Date: 21 August 2019</p>		<p>Plan Number</p> <h1 style="margin: 0;">1.7911</h1> <p>Ref: 3008    Sheet 2 of 4</p>	<p>File number: 835/02/30/0015 Plan reference: Metropolitan Region Scheme 1:25,000 sheet 1 Amending Plans: 1.7910, 1.7911, 1.7912, 1.7913</p>
---	---	--	---	--	---

Signed for and on behalf of the  
Western Australian Planning Commission

---

An officer duly authorised by the Commission  
pursuant to section 24 of the  
Planning and Development Act 2005  
for that purpose in the presence of:

Witness \_\_\_\_\_

Date \_\_\_\_\_

Approved - Minister for Planning \_\_\_\_\_

Date \_\_\_\_\_



Planning control area  
No: 140

**PCA NO. 140 - WANNEROO CITY - BREAKWATER DRIVE**



**Legend**  
 Planning control area

Created on date: Wednesday, 7 August 2019  
 Produced by Data Analytics, Department of Planning, Lands and Heritage, Perth WA  
 Base information supplied by Western Australian Land Information Authority SLIP 1096-2018-1

Program Manager: P. Jahmeerbacus  
 Geospatial Officer: J. Ballarotta  
 Examined: A. Power  
 Revised:  
 Version No: 2  
 Date: 21 August 2019

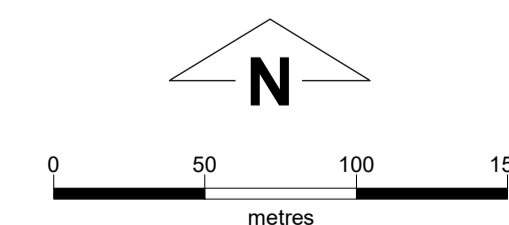

Plan Number  
**1.7912**

Ref: 3008 Sheet 3 of 4

File number: 835/02/30/0015  
 Plan reference:  
 Metropolitan Region Scheme  
 1:25,000 sheet 1  
 Amending Plans:  
 1.7910, 1.7911, 1.7912, 1.7913

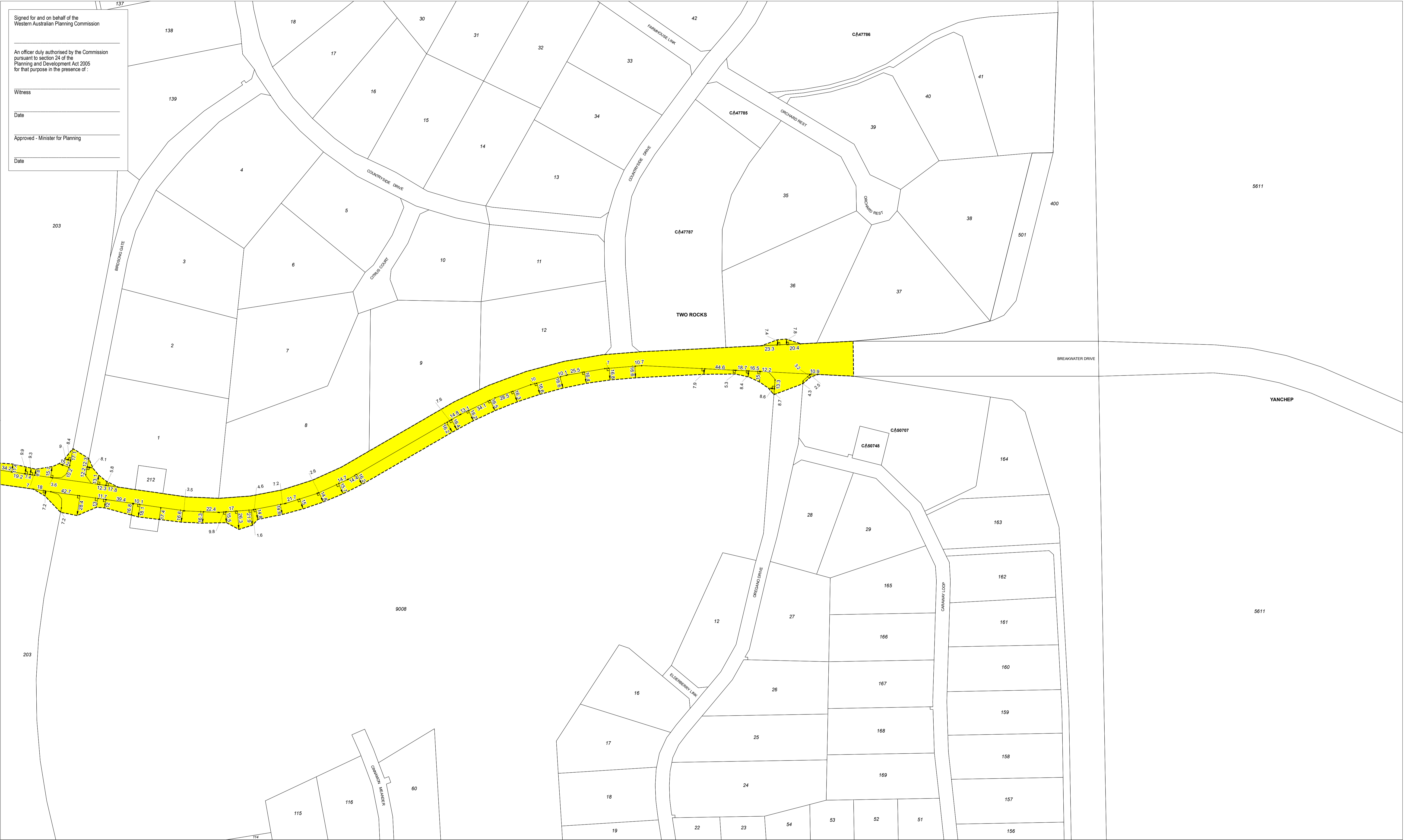

Signed for and on behalf of the  
Western Australian Planning Commission

---

An officer duly authorised by the Commission  
pursuant to section 24 of the  
Planning and Development Act 2005  
for that purpose in the presence of:

Witness \_\_\_\_\_

Date \_\_\_\_\_

Approved - Minister for Planning \_\_\_\_\_

Date \_\_\_\_\_

**Planning control area**  
**No: 140**

**PCA NO. 140 - WANNEROO CITY - BREAKWATER DRIVE**



**Legend**  
 Planning control area

Program Manager: P. Jahmeerbacus  
 Geospatial Officer: J. Ballarotta  
 Examined: A. Power  
 Revised:  
 Version No: 2  
 Date: 21 August 2019

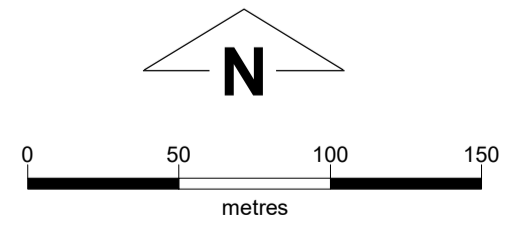

Plan Number  
**1.7913**  
 Ref: 3008 Sheet 4 of 4

File number: 835/02/30/0015  
 Plan reference:  
 Metropolitan Region Scheme  
 1:25,000 sheet 1  
 Amending Plans:  
 1.7910, 1.7911, 1.7912, 1.7913