

# HILL 60 FORESHORE IMPROVEMENT WORKS

## Community update – OCTOBER 2019

### Community information session

Thank you to all those who attended. We believe it was a useful and productive session, and it was beneficial to hear your views first-hand.

### Current status

All necessary approvals for works have been obtained and works are set to commence.

### Next steps

Site works are anticipated to commence before the beginning of November. The following steps are expected to take place this week – the week beginning 21 October.

- Construction site fencing to be installed
- Redirection signage for pedestrians and cyclists being installed

### You asked, we answered

Thank you to those who have been in touch with questions about the project, which we have summarised below.

- Traffic concerns and parking arrangements
  - The contractor has been allocated a parking area near the site and will not be using on-street parking
  - An estimated three to four trucks per day will come onto the site on any given day – but generally this will be limited to one truck at a time and is not anticipated to significantly impact traffic flow in and out of Tanunda Drive.
  - For example, the first truck would arrive onsite at 7am, but due to turnaround times, the next load would not arrive on site until approximately 9am. The final load on any given day would arrive around 3.30pm.
- Tree choice for revegetation
  - Native tree species intended to be planted at the base of the slope are *Allocasuarina fraseriana* (Western or Common Sheoak) and *Eucalyptus rudis* (Flooded or Swamp Gum)

Remember, you can email [media@dplh.wa.gov.au](mailto:media@dplh.wa.gov.au) with any questions or feedback you may have.

Ps – we have included a couple of aerial images denoting detours and traffic management



### Pedestrian detour

Disclaimer: This plan has been prepared as a guide for Traffic Management purposes. Workforce Road Services disclaims all responsibility and liability (including without limitation, liability in negligence) for all expenses, losses, damages and costs you might incur as a result of the information being inaccurate or incomplete in any way, and for any reason.

SPOTTER TO GIVE BREAKS AS PER AS/AS 2.2.2006  
AND NSWRA CODE OF PRACTICE

- WORK AREA
  - FOOTPATH
  - TRAFFIC CONTROLLER
  - SPOTTER
  - CONES
- TRUCK ENTRY/EXIT
  - TEMP FENCE
  - SILT CURTAIN
  - LOADING/UNLOAD AREA
  - TREE PROTECTION ZONE
  - TEMP GATE
  - PED DETOUR
  - CONVEYOR BELT
  - POSY TRACK

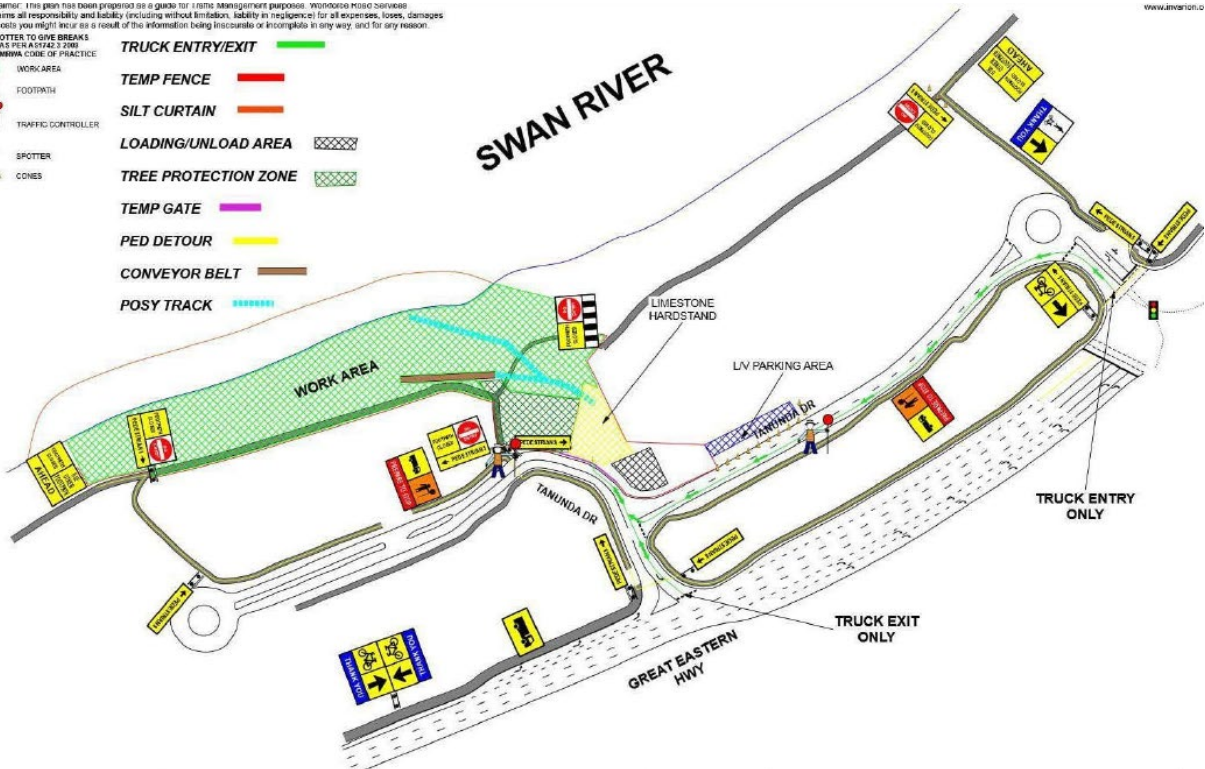

### Traffic management